

## 1. Delivery Contents

- Robot x 1
- Controller x 1
- Instruction Manual x 1

## 2. Battery Installation

Make sure the power switch is on "OFF" position.

### Controller

- Open the battery compartment: loosen the screw by turning counter clockwise with a Philips screwdriver. (Fig.1)
- Insert 3 AA batteries in the battery compartment with correct polarity. (Fig.2)
- Close the battery compartment: tighten the screw by turning clockwise with a Philips screwdriver.

### Robot

- Open the battery compartment: loosen the screw by turning counter clockwise with a Philips screwdriver. (Fig.3)
- Insert 6 AA batteries in the battery compartment with correct polarity. (Fig.4)
- Close the battery compartment: tighten the screw by turning clockwise with a Philips screwdriver.

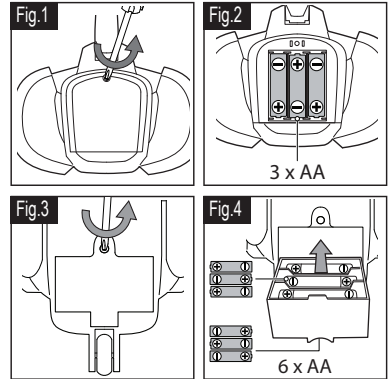

## 3. Part Identification

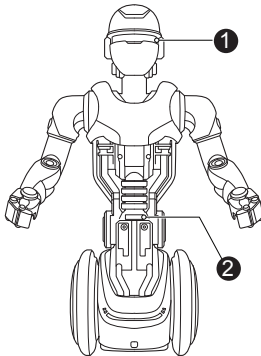

1. LED Eyes (Robot)
2. Demo Button
3. Microphone
4. Power Switch / Auto mode / Manual mode
5. Wheels Direction Control Lever
6. Tracking (pre-programming)
7. Execute (enter / playback)
8. Left Shoulder + Elbow Control Pad

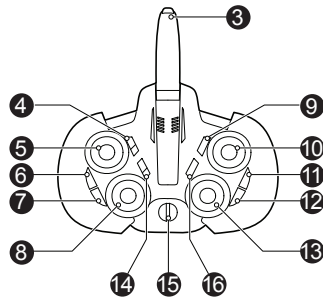

9. Demo Button
10. Head Direction Control Pad
11. Press to Talk Button (for Live Broadcast)
12. Repeat Button (for Live Broadcast)
13. Right Shoulder + Elbow Control Pad
14. Save Slot Selection (for Tracking Function)
15. Voice Changing Effect Selector
16. Monitoring ON/OFF button

## 4. General Feature

- Lively motions – motorized head, shoulder & Elbows
- All Directional control – motorized wheels
- Dance – Performs 5 demo dances
- Spy Feature – listen Robot's surrounding sound on the controller's speaker
- Live Broadcast – Talk to the controller and broadcast via the Robot
- Voice Change – broadcast your voices in 5 preset voice changed effects
- Code Tracking – records & playback the customize movements in 3 sets of memories

## 5. How To Play

### 5.1 STAR TO PLAY

- To prevent any damage caused by falling, do not play the robot on a table or raised surfaces. (Fig.5)
- It is recommended to play the robot on a flat and smooth surface or short pile carpet, unsmooth surfaces or long pile carpet will affect the robot's performance
- Make sure the robot is in a vertical position, slide its Power Switch to ON position
- Slide the Power Switch of the controller to AUTO or MANUAL mode position. (Fig.6)
- If the light indicator on the controller turns from blinking to still, the robot and the controller are successfully connected and it is ready to play.
- If the light indicator on the controller keeps blinking, turn off the Robot and controller then turn on again, repeat the steps above for connecting again.
- In an AUTO mode – the Robot's head and arms will move automatically, but they can still be controlled manually.
- In a MANUAL mode – the movement of Robot's head and arms will only be controlled manually.

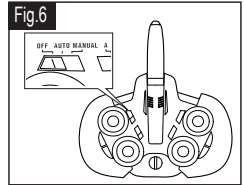
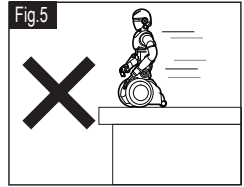

### 5.2 ORIENTATION SENSING

- The Robot will generate warning sound effects & stops all in-progress motions if it is not vertically placed or fall over.
- Place the robot in an upright position to disable the warning sound effect.

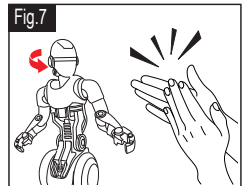

### 5.3 SOUND SENSOR

- When the Robot is in idle status, it will response to the sound commands, clap or make sound noises and Robot will turn its head to the sound direction. (Fig.7)

### 5.4 DEMO

- Press the DEMO button on the controller or the Robot to play a demo dance. (Fig.8 and 9)
- The Robot contains 5 demo dances, press the button from 1 to 5 times to select a dance.
- During the dance, press the Demo button once to stop.

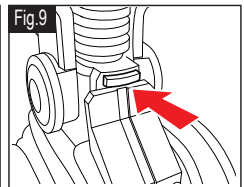
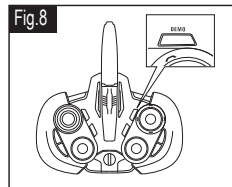

### 5.5 DIRECT CONTROL

- Use the controller to control the Robot's movements
- Robot's directional movement - Joystick (Fig.10)
- Head up/down & Head turning Left/Right – Directional pad 1 (Fig.11)
- Robot's Left shoulder & elbow movement - Directional pad 2 (Fig.12)
- Robot's Right shoulder & elbow movement - Directional pad 3 (Fig.12)

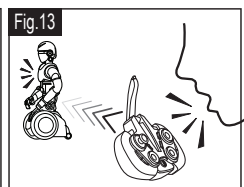
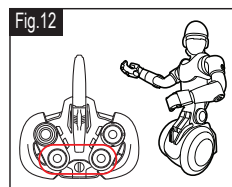
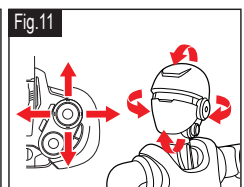
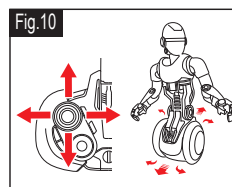

### 5.6 LIVE BROADCAST

- Pull up the Microphone, select a Voice Effect by turning the VOICE CHANGE knob(V1-V5) (Fig.13)
- Press & hold the TALK button until the controller generates a "BEEP" sound
- Facing to the microphone to talk & the messages will be transmitted through the speaker on the robot with voice changing effect
- Release the TALK button & the controller generates a "BEEP BEEP" sound
- Press the REPEAT button once to play back the message once
- Press the REPEAT button twice to loop the message. Press the button again to stop

**Remarks: The recorded message will be replaced if there is a new message input.**

### 5.7 SPY FEATURE

- To listen to the sound picked up by the robot, press the MONITOR button on the controller once. (Fig.14)
- During the spying, the light indicator on the controller will flash slowly.
- Press the monitoring button again to cancel the monitoring

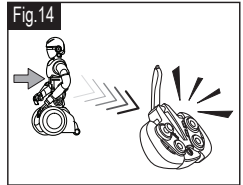

### 5.8 CODE TRACKER FEATURE

- The robot is able to memorize 3 sets of arms and head movements, each set stores up to 30 steps.
  - Select one of the memories (A/B/C) by sliding the MEMORY selector, press the TRACKING button until you hear a "Beep Beep Beep" sound to start step recording. (Fig.15)
  - Use the directional pads to control the head, shoulder or elbow to the posture you want.
  - Press the EXECUTE button to confirm the step input. (Fig.16)
  - Repeat above steps for next step input
  - After the last step input, press the TRACKING button again to save the input steps.
  - Press the EXECUTE button to playback the memorized steps. You can use the joystick to control wheel movements
  - During the playback, you can broadcast a message by using the LIVE BROADCAST feature or pick up the sounds from the Robot by using SPY feature.
- Remarks: The recorded steps will be replaced if there is a new step input.

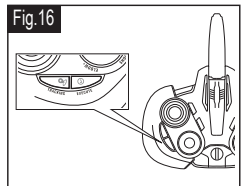
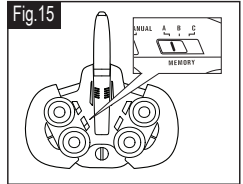

### 5.9 POWER SAVING

- If the Robot is idled without any input received, it will stop all the movements & enter SLEEP mode after 3 minutes & 10 minutes respectively.
- To wake up the Robot from SLEEP mode, slide the Power switch of Robot and Controller to OFF position then turn ON again

### 5.10 TROUBLESHOOTING

- The robot is not connected to the Controller – Switch off both Robot and Controller then turn it on again.
- Robot keep generates a warning sound – place the Robot in an upright position. If the Warning still exists, switch off the power and then turn it on again.
- The robot has no responses – Switch off both Robot and Controller the turn it on again.